

VILLA REFINADA

TRADITIONAL & UNIQUE | TRADITIONAL PORTUGAL



4 Bedrooms



8 Guests



POA

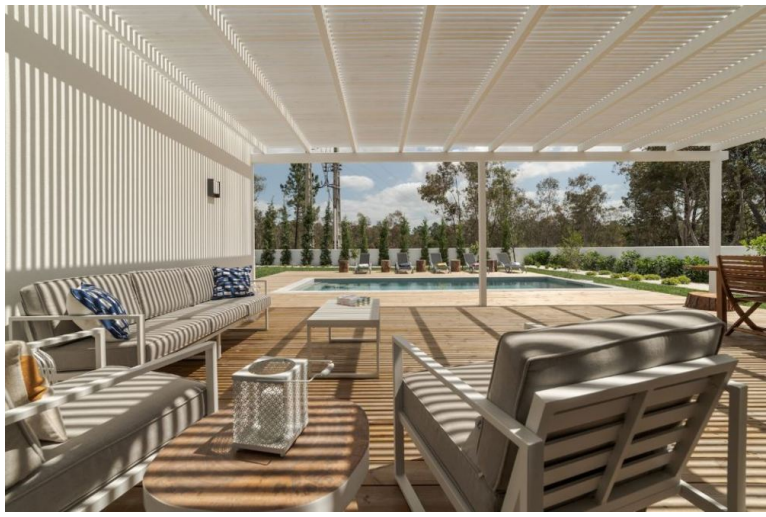

- > Air Conditioning
- > Chef service available
- > Family villa
- > Near shops/restaurants
- > Near the beach
- > Romantic villa
- > With cot / highchair
- > With WIFI

"An exclusive designer villa with pool and impeccably designed interiors for a family holiday in the sought after stretch of coast around Comporta, surrounded by rice fields and pine forests within a short stroll from a local village and close to the beach".

With the accommodation all on one floor, large open plan space and easy access to the manicured gardens and pool area and large open plan space, this villa lends itself for easy living whilst on holiday in this trendy region of Portugal. The region's best beaches are only a short drive away or bike ride between rice paddies – bicycles are provided at the villa so guests will enjoy a bike ride to the nearby beaches of Praia do Carvalhal and Praia do Pego where you can go horse riding or surfing or stand-up paddling or just sit back and watch the sunset from one of the local beach bars.

ACCOMMODATION

(160 m²)

Indoors:

Spacious open plan living/ dining room/ kitchen/ breakfast bar, feature fireplace, Sat TV, door to decked terrace covered by a shady pergola for outdoor meals and chilling out.

Bedroom 1: double bedroom (bed size: 1.60 m x 2.00 m), en-suite shower room.

Bedroom 2: double bedroom (bed size: 1.60 m x 2.00 m), en-suite shower room.

Bedroom 3: twin bedrooms (2 beds sized: 0.90 m x 2.00 m).

Bedroom 4: twin bedrooms (2 beds sized: 0.90 m x 2.00 m).

Shower room.

Grounds:

750 m² private grounds. Private 8m x 3m swimming pool (depth: 1.70 m; Roman steps), sunbathing area, poolside furniture. Football goalpost; bicycles for guests to use. Parking for two cars inside property walls.

DISTANCES

Carregueira de Brejos de Cima village (basic cafés/restaurants): walking distance.

Carvalhal village (cafés/ restaurants & bars/ supermarkets & small grocery shop): 2.5 km.

Comporta (trendy shops/ restaurants): 8 km.

Grandola (nearest hypermarket): 24 km.

Praia do Carvalhal (beach): 6.5 km.

Praia do Pego (beach): 8 km.

Aberta Nova (beach): 27 km.

Troia Golf Course: 22.5 km.

Alcacer do Sal: 36.5 km.

Lisbon Airport: 123 km.